



Model Number:
WGBKX-1908

RF Components

K-Band Waveguide Bend

18.00-26.50 GHz

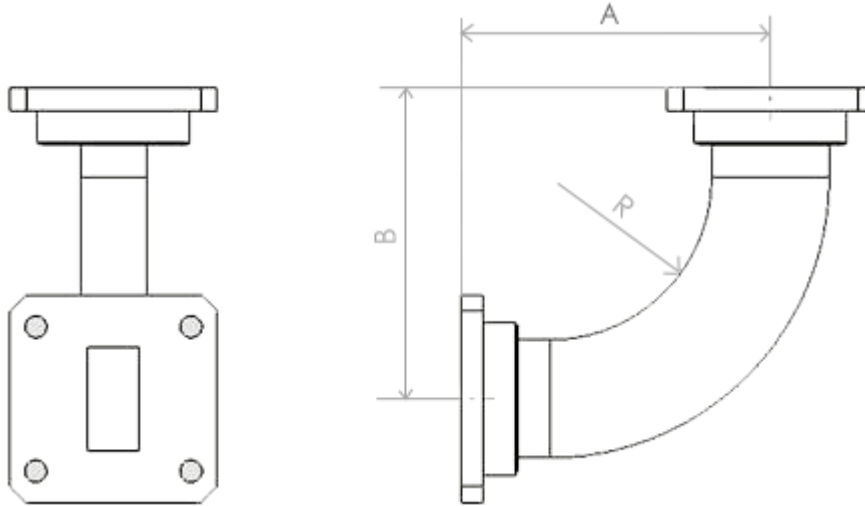

| Specification | | |
|------------------------|---|----------------------|
| WGBKX-1908 | E Bend / H Bend | |
| Waveguide Size | WG20 / WR42 / R220 | |
| Flange 1 | UBR 220 | UG 220 Flat |
| Flange 2 | PBR 220 | UG 220 Seal /Grooved |
| Flange Material/Finish | Brass Flanges Copper WG Black Paint | |
| Frequency Range | 18.00-26.50 GHz | |
| VSWR / Return Loss | 1.1 / 25.6 dB | |
| Dimension A | 70 mm | 200mm |
| Dimension B | 70 mm | 200mm |
| Bend Angle | 90 degrees | |
| Radius | 20 mm | |

Broadcast



Marine Oil & Gas



SNG & VSAT



Satellite Teleport

